

Requires the installation of a :

Gateway module

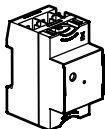

OR

Connected Starter Pack
"... with Netatmo"

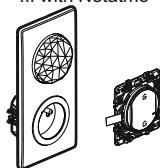

Composition

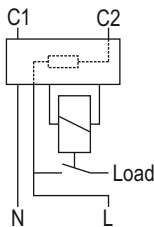
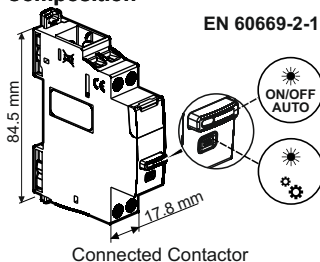

Control wiring authorized

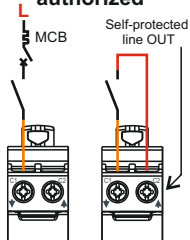

	U	I	F						
-5°C +45°C	100-240V~ 50/60Hz	20A MAX	2.4 à 2,4835Ghz <100 mW	Silent < 10dB	Planning	Measure	4800W	2400VA	Charging electric cars

Imperative security precaution



Failure to strictly comply with the installation and use conditions may result in risk of electric shock or fire.

1 Preparation, connection

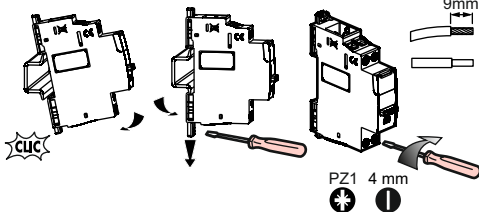
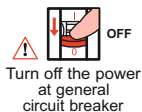

C1, C2: MAX 2x 1.5mm ² 2.5mm ²
N, L, Load: MAX 2x 2.5mm ² 6mm ²
C1,C2, N, L, Load: MIN : 0.8Nm MAX : 1.4Nm

Wiring examples

Thanks to its control circuit with integrated power and protection, you no longer need to install a circuit breaker 2A to protect the control circuit if you wire a contact between C1 and C2

A load protection circuit breaker with appropriate rating is required

controlled by the energy supplier electric meter

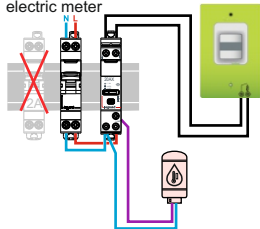

Swimming pool pump and another motors

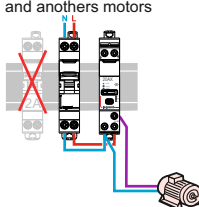

Charging electric cars

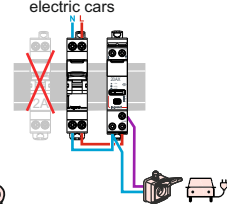

Control of heaters through an installed central remote

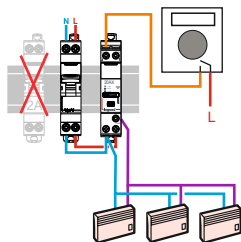

Control of a power single line contactor by a connected contactor *

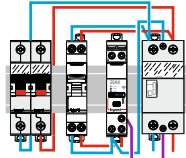

Control of a power three lines contactor by a connected contactor *

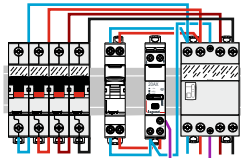

*: Non-functional consumption measurement when controlling a single line or a three lines power contactor by a connected contactor.

— N (neutral) = blue

— L (Line) = Everything but blue and green/yellow

— Line after contact = usually purple, orange...

2 Add the **Contactor** in a connected installation

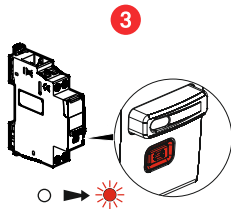
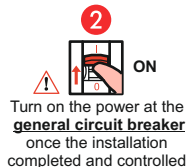
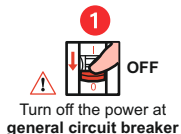

3 **Press and hold** the Gateway module settings button, **or** in the center of the General Scenario Wireless Command until the LED turns green, then **release the button**.

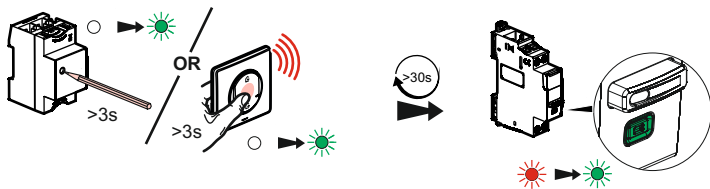

The configuration LEDs of " ... with Netatmo " devices must all light up in fixed green.

4 Complete the installation

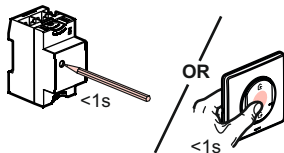

Briefly press the setting button on the Gateway module (or in the center of the General Scenario Wireless Command) to finalize the installation. All devices LED go OFF.

5 Finalize the installation in the Legrand Home + Control app

To add this connected product and peripheral items in your connected installation, you must follow the instructions:

- with Legrand Home + Control app

(Parameters/Add new product)

- or consult the guides and instructions sheets on legrand.fr



Use by manual control and status LED

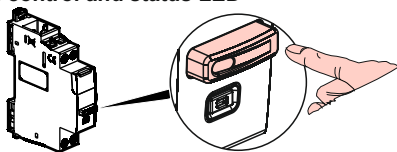

Automatic Mode

OFF



AUTO OFF



AUTO ON

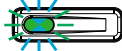

ON



ON/OFF Mode

OFF



ON



www.legrand.fr/reference/412171

LEGRAND - Pro and Consumer Service - BP 30076
87002 LIMOGES CEDEX FRANCE • www.legrand.com

EU SIMPLIFIED DECLARATION OF CONFORMITY

The undersigned,

Legrand

declares that the radio equipment listed on this instruction sheet
are compliant to the directive 2014/53/UE.

The full text of the EU declaration of conformity
is available at the following website:

www.legrandoc.com