

This pack is a connected accessory which **requires** you to buy and install the «... with Netatmo» connected starter pack first.

Pack contents

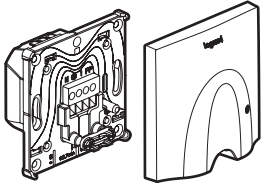

Connected cable outlet Finishing plate outlet

Electrical characteristics

| | | |
|---------------------|-------------------------|------------------------|
| +45° C +5° C | 2,5 mm ² | 200 000 actuations |
| | | 3000 W |
| 50/60 Hz | | |
| 230 Vac | Maxi. | |

The circuit must be protected with a 16A breaker

Before you start : wiring precautions

To control a connected cable outlet, only use these products :

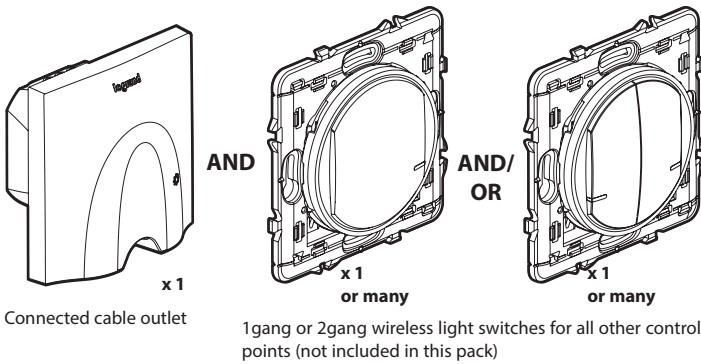

x 1
Connected cable outlet

AND

x 1
or many

AND/
OR

x 1
or many

1gang or 2gang wireless light switches for all other control points (not included in this pack)

LE1208AA

CASE N° 1 - Appliance installed without pilote wire

(By default factory mode)

Note : in that case, the connected cable outlet can be controlled by wireless light switches.

Necessary safety precautions

1 OFF
Switch off the power at the main circuit breaker

2 Make sure that the power is off before continuing with the installation.

3 Remove the existing cable outlet (with or without pilot wire)

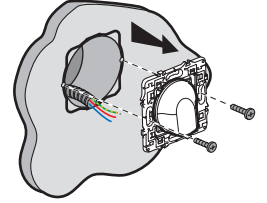

4 Wire the connected cable outlet

2,5 mm² rigid wire (recommended)

14 A - 230 V~
3000 W maxi

Frequency bands: 2.4 - 2.4835 GHz
Power level: < 100 mW

- N (neutral) = blue
- L (live) = all except blue and yellow
- ⊕ (earth) = green/yellow

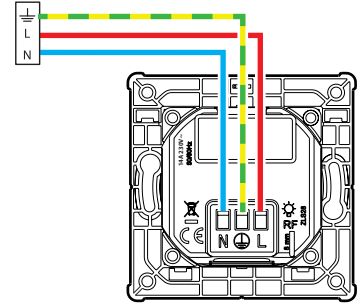

2

5 Wire the appliance on your connected cable outlet

Appliance installed without pilot wire

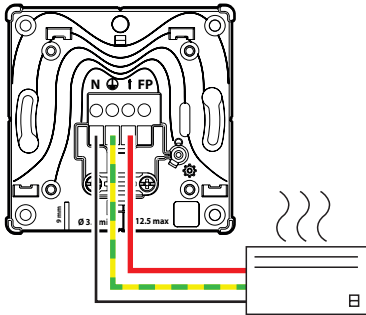

Authorized cables H05 VVF or H07 RNF
For cables Ø maxi. 12,5 mm
Ø mini. 3,7 mm

CASE N° 2

Appliance installed with pilot wire(*) and without energy manager

Pilot wire function activable in Legrand Home+Control app.

Note : enabling the pilot wire feature makes the wireless light switches inoperable on the connected cable outlet.

(*) Pilot wire 4/6 orders (read your appliance instruction sheet)

Necessary safety precautions

1 OFF
Switch off the power at the main circuit breaker

2 Make sure that the power is off before continuing with the installation.

3 Remove the existing cable outlet

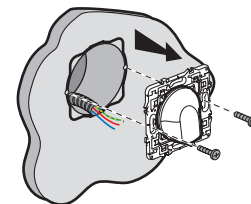

Remove the existing cable outlet

4 Wire the connected cable outlet

2,5 mm² rigid wire
(recommended)

14 A - 230 V~
3000 W maxi

Frequency bands: 2.4 - 2.4835 GHz

Power level: < 100 mW

— N (neutral) = blue

— L (live) = all except blue and yellow

— ⚡ (earth) = green/yellow

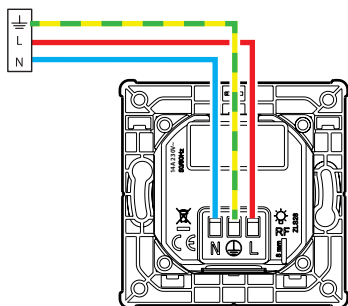

5 Wire the appliance on your connected cable outlet

Appliance installed with pilot wire(*) and without energy manager

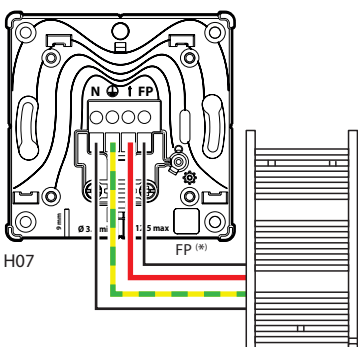

Authorized cables H05 VVF or H07 RNF
For cables Ø maxi. 12,5 mm
Ø mini. 3,7 mm

5

CASE N° 3

Appliance installed with pilot wire(*) and with energy manager
Pilot wire function activable in Legrand Home+Control app.

Note : enabling the pilot wire feature makes the wireless light switches inoperable on the connected cable outlet.

(*) Pilot wire 4/6 orders (read your appliance instruction sheet)

Necessary safety precautions

1



OFF
Switch off the power at the main circuit breaker

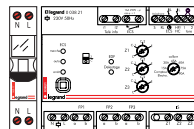

OFF
Switch off the energy manager power at its circuit breaker

AND

2



Make sure that the power is off before continuing with the installation.

3 Remove the existing cable outlet (see § 3 page 2)

4 Wire the connected cable outlet

2,5 mm² rigid wire
(recommended)

14 A - 230 V~
3000 W maxi

Frequency bands: 2.4 - 2.4835 GHz

Power level: < 100 mW

— N (neutral) = blue

— L (live) = all except blue and yellow

— ⚡ (earth) = green/yellow

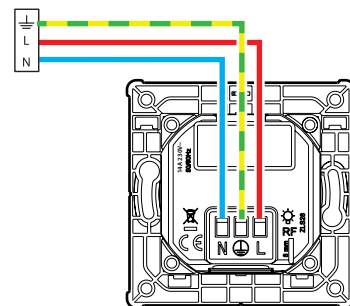

6



The cable outlet will replace the energy manager functionalities for the connected appliance.

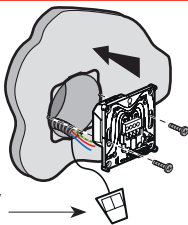

Make sure to isolate the pilot wire of the current energy manager with a Nylbloc connector (not supplied).

5 Wire the appliance on your connected cable outlet

Appliance installed with pilot wire(*)

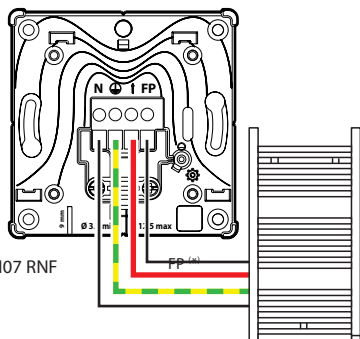

Authorized cables H05 VVF or H07 RNF
For cables Ø maxi. 12,5 mm
Ø mini. 3,7 mm

7

To add a connected product to your connected installation, you should follow the instructions:

- in the **Legrand Home + Control application (Settings/Add a new product section)**
- or consult the user manual on **legrand.fr**



www.legrand.fr

LEGRAND - Pro and Consumer Service - BP 30076
87002 LIMOGES CEDEX FRANCE • www.legrand.com

⚠ Safety instructions

This product should be installed in compliance with installation rules, preferably by a qualified electrician. Incorrect installation and/or incorrect use can lead to risk of electric shock or fire. Before carrying out the installation, read the instructions and take account of the product's specific mounting location. Do not open up, dismantle, alter or modify the device except where specifically required to do so by the instructions. All **Legrand** products must be opened and repaired exclusively by personnel trained and approved by **Legrand**. Any unauthorised opening or repair completely cancels all liabilities and the rights to replacement and guarantees. Use only **Legrand** brand accessories.

Install the cover plate on the cable outlet

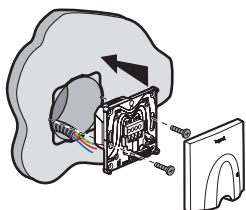

ON

Switch on the power at the main breaker.

SIMPLIFIED EU DECLARATION OF CONFORMITY

The undersigned,

Legrand

declares that the radio-electric equipment referred to in these instructions complies with directive 2014/53/EU.

The full text of the EU declaration of conformity is available on the following website :

www.legrandoc.com