

# DPX™-IS 250 isolating switches

63 to 250 A

## ■ Dimensions

### Front handle

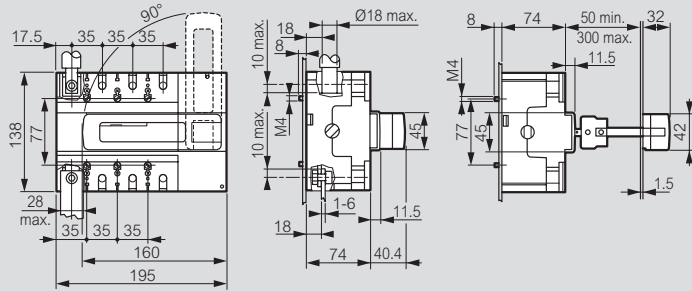

### Right hand side handle

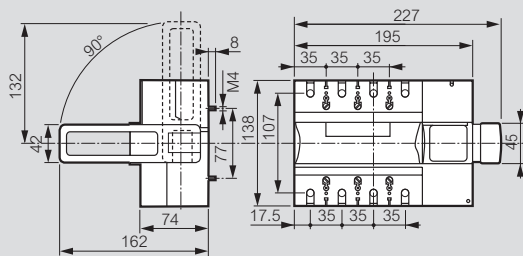

### Left hand side handle

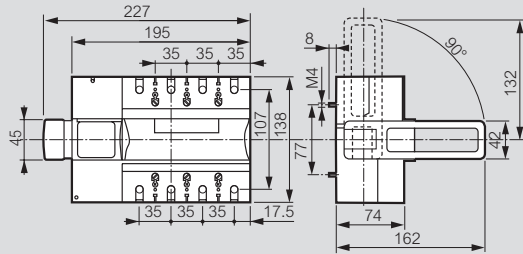

### Mounted on rail

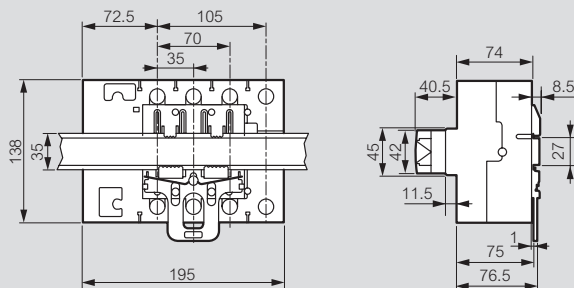

## With terminal shields

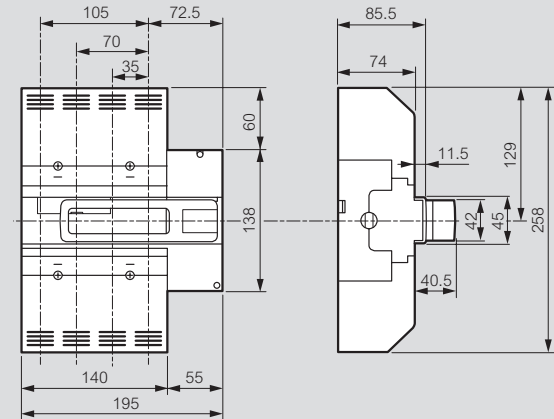

## ■ Mounting

Mounted on rail with plate (XL<sup>3</sup> 400, XL<sup>3</sup> 800 and XL<sup>3</sup> 4000)

