

**Prisinter - panel mounting sockets - LV 16-32-63 A (p. 390)**

Terminal connection (max.)  
 BT 16 A : rigid - 1 x 4 mm<sup>2</sup>  
 BT 32 A : rigid - 1 x 10 mm<sup>2</sup>  
 BT 63 A : rigid - 1 x 25 mm<sup>2</sup>  
 Prisinter sockets 32 A : flexible - 1 x 6 mm<sup>2</sup>  
 Prisinter sockets 63 A : flexible - 1 x 16 mm<sup>2</sup>  
 Conform to EN 60309-1, NF EN 60309-2, IEC 60309-1 and IEC 60309-2  
 IK 09 : plastic and rubber  
 IK 10 : metal according to EN 62262 et IEC 62262  
 Self-extinguishing :  
 850 °C support of active parts, 950 °C for Prisinter  
 650 °C plastic housing  
 - 50 °C à + 100 °C (- 20 °C for Prisinter)  
 Icc 10 kA according to EN 60309-1 and IEC 60309-1  
 Dust resistance IP may be increased by rubber push-button (on request)

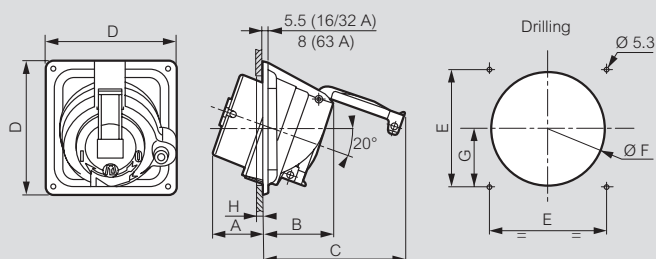

	Material	Weight (kg)	A	B	C	D	E	F		G	H max
								min	max		
<b>16 A</b>											
2P+E	Plastic	0.420	46	70	132	115	100	92	98	46	6 to 10
	Metal	1.250									
3P+E	Plastic	0.480	46	70	138	115	100	92	96	46	6 to 10
	Metal	1.330									
3P+N+E	Plastic	0.570	46	75	156	125	110	102	106	51.5	7
	Metal	1.470									
<b>32 A</b>											
2P+E	Plastic	0.570	54	77	153	143	125	115	122	58.5	10 to 20
	Metal	1.470									
3P+E	Plastic	0.610	54	77	153	143	125	115	122	58.5	10 to 20
	Metal	1.500									
3P+N+E	Plastic	0.650	55	79	169	143	125	119	122	58.5	9 to 13
	Metal	1.800									
<b>63 A</b>											
2P+E	Plastic	0.870	55	99	205	143	125	120	122	59.5	10 to 20
	Metal	1.500									
3P+E	Plastic	0.950	55	99	205	143	125	120	122	59.5	10 to 20
	Metal	1.850									
3P+N+E	Plastic	0.980	55	99	205	143	125	120	122	59.5	10 to 20
	Metal	2.200									

**Breaking capacity 3 x 400 V~ according to IEC 60947-1-3**

Category	16 A	32 A	63 A	Category	125 A	
AC 1	16 A	32 A	63 A	AC 22 AC 23	400 V	70 kW
AC 23	8.4 kW	16.8 kW	33 kW		500 V	87 kW
AC 3					600 V	120 kW

**Reversible box for Prisinter sockets**

**LV 16 A (p. 390)**

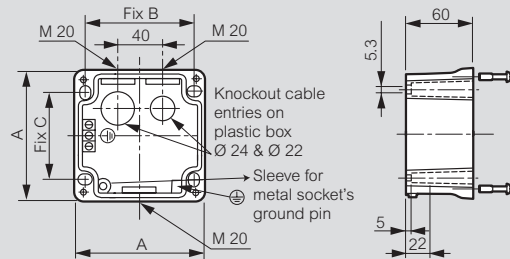

3 entries among which  
 2 entries M20 sealed with B20P blanking plug for auxiliary contact use  
 Fitted with 2 connected earth terminals and 1 outside terminal on metal box

	Material	Weight (kg)	A (mm)	B (mm)	C (mm)
2P+E	Plastic	0.140	115	97	78
	Metal	0.800			
3P+N+E	Plastic	0.160	125	107	88
	Metal	0.900			

**LV 32 A (p. 390)**

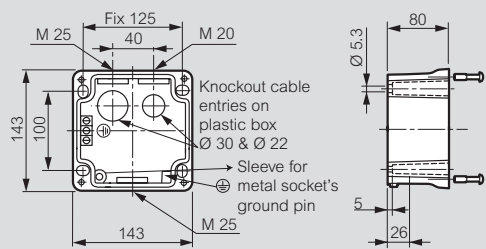

3 entries among which  
 1 M20 sealed with B20P blanking plug for auxiliary contact  
 1 M25 sealed with B25P blanking plug  
 Fitted with 2 connected earth terminals and 1 outside terminal on metal box

**LV 63 A (p. 390)**

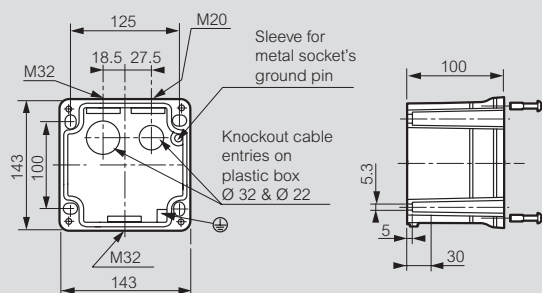

3 entries among which  
 1 M20 sealed with B20P blanking plug for auxiliary contact  
 1 M32 sealed with B32P blanking plug  
 Fitted with 1 outside earth terminal on metal box

 Dust resistance IP can be increased by a rubber push-button,  
**On special request**

