

# Supply busbars, entry terminals

"standard" distribution

## Use of supply busbars

### Universal single phase + neutral

- blue for neutral
- black for live

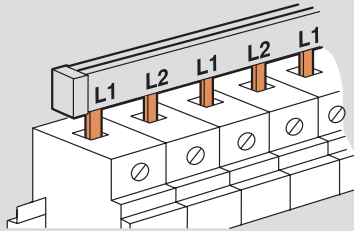

### Entry terminal

Power supply at the rear of the busbar  
For all devices with moving cage terminals

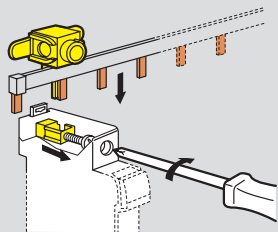

Power supply at the front of the busbar  
For all devices with fixed cage terminals

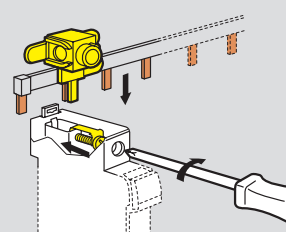

### Four pole busbar

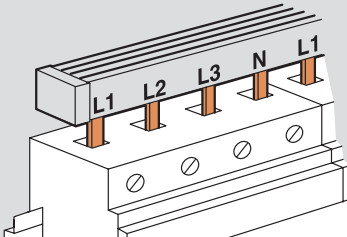

## Technical characteristics

	Busbars type	Max number of devices connected	Length in number of 17.5 mm modules	Cross section (mm <sup>2</sup> )	Permissible current	
					1 central power supply point	2 power supply point
Single pole or Single pole + neutral	1 row	13	13	16 <sup>2</sup>	80	100
	Meter	57	57			
Double pole	1 row	6	12	10 <sup>2</sup>	63	90
	Meter	28	56	16 <sup>2</sup>	80	100
Double pole balanced on 3-phases	1 row	6	12	10 <sup>2</sup>	63	90
	Meter	28	56	16 <sup>2</sup>	80	100
Triple pole	1 row	4	12	10 <sup>2</sup>	63	90
	Meter	19	57	16 <sup>2</sup>	80	100
Four pole	1 row	3	12	10 <sup>2</sup>	63	90
	Meter	14	56	16 <sup>2</sup>	80	100