

## Electrical energy metering on door



0 146 00 + 0 146 16



0 146 61



0 495 55

Ammeters, voltmeters, totalising, can be mounted on XL<sup>3</sup> 800 and XL<sup>3</sup> 4000 curved doors

### Pack Cat.Nos Analogue metering devices

Pack	Cat.Nos	Analogue metering devices
		<b>Ammeters</b>
		Measure the intensity in amperes (A) of the current Connected via a 0 - 5 A output current transformer (CT) To be fitted with a measuring dial appropriate for the current to be measured
1	0 146 00	Round barrel Ø56 mm
1	0 146 01	Square barrel 68 x 68 mm
		<b>Measuring dial for ammeters</b>
		Supplied by set of 2 (1 for round barrel, 1 for square barrel)
1	0 146 10	0 - 50 A
1	0 146 13	0 - 100 A
1	0 146 15	0 - 200 A
1	0 146 16	0 - 250 A
1	0 146 17	0 - 300 A
1	0 146 18	0 - 400 A
1	0 146 20	0 - 600 A
1	0 146 21	0 - 800 A
1	0 146 22	0 - 1000 A
1	0 146 66	0 - 1250 A
1	0 146 24	0 - 1500 A
1	0 146 25	0 - 2000 A
1	0 146 26	0 - 2500 A
1	0 146 28	0 - 4000 A
		<b>Voltmeters</b>
		Measure the voltage in volts (V) AC ou DC Scale: 0 - 500 V
1	0 146 60	Round barrel Ø56 mm
1	0 146 61	Square barrel 68 x 68 mm

### Totalising hour counters (48 x 48)

		One-piece device - IP 40 Front mounting on enclosure or cabinet doors Synchronous motor operation (operation indicator) For counting the operating hours of an electrical machine or device, with no reset Supplied with cover frame (55 x 55 mm) (for round cut-out) and fixing accessories Connection: 2 x 1.5 mm <sup>2</sup>
1	0 495 52	24 V~ - 50 Hz
1	0 495 53	110 to 120 V~ - 50 Hz
1	0 495 54	110 to 120 V~ - 60 Hz
1	0 495 55	200 to 240 V~ - 50 Hz
1	0 495 58	48 V~ - 50 Hz
1	0 495 59	400 V~ - 50 Hz
1	0 495 60	12 to 36 V=
100	0 495 97	Frame 55 x 55 mm

## Electrical energy metering

### ■ Metering devices on rail

#### Technical characteristics

Analogue ammeters

Type of measurement	Analogue	
	Ferromagnetic	
Frequency	50 to 60 Hz	
Precision	1.5 %	
Operating temperature	- 10 °C to + 40 °C	
Storage temperature	- 20 °C to + 80 °C	
Consumption:		
• voltage circuit	-	
• measurement circuit	1.1 VA	
Connection capacity	Direct 6 mm <sup>2</sup>	Par TI 4 mm <sup>2</sup>
Conformity to standards	NF EN 61010-1	

Analogue Voltmeters

Type of measurement	Analogue	
	Ferromagnetic integration	
Frequency	50 to 60 Hz	
Precision	1.5 %	
Operating temperature	- 10 °C to + 40 °C	
Storage temperature	- 20 °C to + 80 °C	
Consumption	3 VA	
Connection capacity	2 x 2.5 mm <sup>2</sup>	
Conformity to standards	NF EN 61010-1	

Digital frequency meter

Type of measurement	Quartz electronic
Precision	± 0.2 % for ± 1 digit
Operating temperature	- 10 °C to + 40 °C
Storage temperature	- 20 °C to + 70 °C
Consumption	4.5 VA
Connection capacity	2 x 2.5 mm <sup>2</sup>
Conformity to standards	NF EN 61010-1

### ■ Analogue metering devices on door

#### Technical characteristics

Frequency: 50/60 Hz  
Precision class: 1.5 %  
Operating temperature: - 10 °C to + 40 °C  
Storage temperature: - 20 °C to + 80 °C  
Consumption:  
- ammeter: 1.1 VA  
- voltmeter: 3 VA  
Connection capacity: 2 x 2.5 mm<sup>2</sup> with screws or  
Conform to IEC 60051, VDE 0410, BS 89,  
EN 60051-1, cenelec HD 223

#### Dimensions

Cat.Nos 0 146 01/61

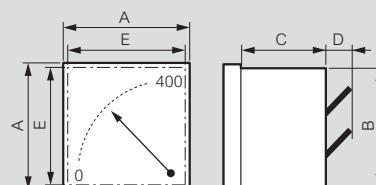

Dimensions (mm)				
A	B	C	D	E
72	66.5	44	12	68±0,7

Cat.Nos 0 146 00/60

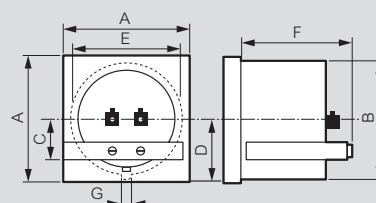

Dimensions (mm)						
A	B	C	D	E	F	G
72	Ø55	21.4	28.5	56	46	3.2